

OPTION 1

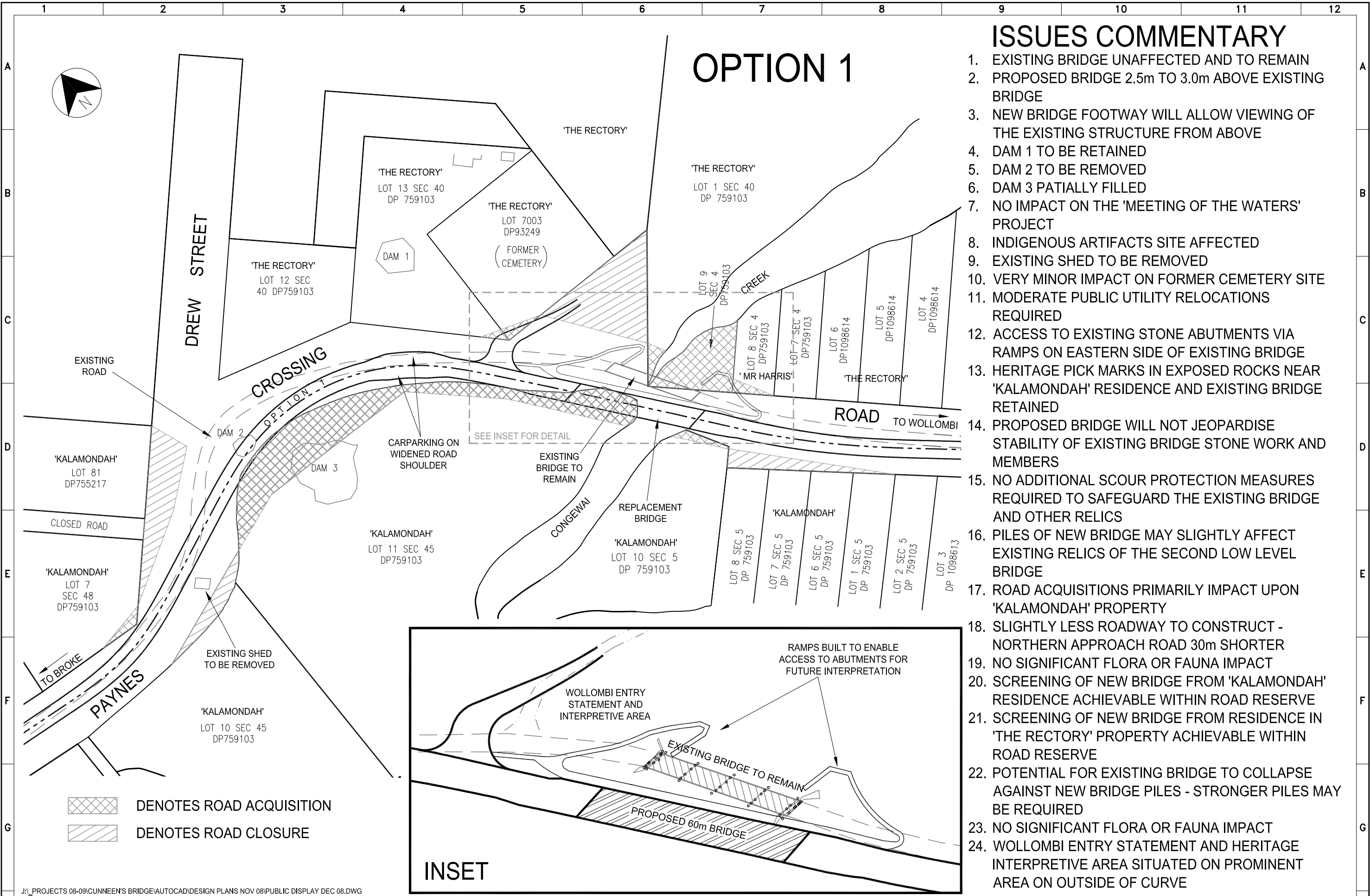

ISSUES COMMENTARY

1. EXISTING BRIDGE UNAFFECTED AND TO REMAIN
2. PROPOSED BRIDGE 2.5m TO 3.0m ABOVE EXISTING BRIDGE
3. NEW BRIDGE FOOTWAY WILL ALLOW VIEWING OF THE EXISTING STRUCTURE FROM ABOVE
4. DAM 1 TO BE RETAINED
5. DAM 2 TO BE REMOVED
6. DAM 3 PARTIALLY FILLED
7. NO IMPACT ON THE 'MEETING OF THE WATERS' PROJECT
8. INDIGENOUS ARTIFACTS SITE AFFECTED
9. EXISTING SHED TO BE REMOVED
10. VERY MINOR IMPACT ON FORMER CEMETERY SITE
11. MODERATE PUBLIC UTILITY RELOCATIONS REQUIRED
12. ACCESS TO EXISTING STONE ABUTMENTS VIA RAMPS ON EASTERN SIDE OF EXISTING BRIDGE
13. HERITAGE PICK MARKS IN EXPOSED ROCKS NEAR 'KALAMONDAH' RESIDENCE AND EXISTING BRIDGE RETAINED
14. PROPOSED BRIDGE WILL NOT JEOPARDISE STABILITY OF EXISTING BRIDGE STONE WORK AND MEMBERS
15. NO ADDITIONAL SCOUR PROTECTION MEASURES REQUIRED TO SAFEGUARD THE EXISTING BRIDGE AND OTHER RELICS
16. PILES OF NEW BRIDGE MAY SLIGHTLY AFFECT EXISTING RELICS OF THE SECOND LOW LEVEL BRIDGE
17. ROAD ACQUISITIONS PRIMARILY IMPACT UPON 'KALAMONDAH' PROPERTY
18. SLIGHTLY LESS ROADWAY TO CONSTRUCT - NORTHERN APPROACH ROAD 30m SHORTER
19. NO SIGNIFICANT FLORA OR FAUNA IMPACT
20. SCREENING OF NEW BRIDGE FROM 'KALAMONDAH' RESIDENCE ACHIEVABLE WITHIN ROAD RESERVE
21. SCREENING OF NEW BRIDGE FROM RESIDENCE IN 'THE RECTORY' PROPERTY ACHIEVABLE WITHIN ROAD RESERVE
22. POTENTIAL FOR EXISTING BRIDGE TO COLLAPSE AGAINST NEW BRIDGE PILES - STRONGER PILES MAY BE REQUIRED
23. NO SIGNIFICANT FLORA OR FAUNA IMPACT
24. WOLLOMBI ENTRY STATEMENT AND HERITAGE INTERPRETIVE AREA SITUATED ON PROMINENT AREA ON OUTSIDE OF CURVE

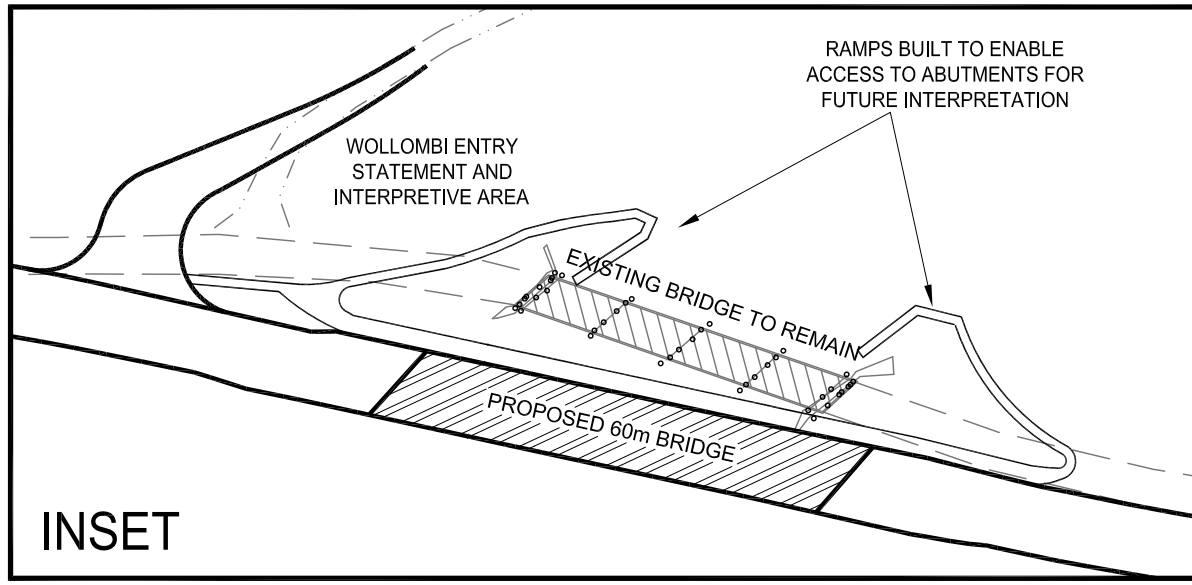

J:_PROJECTS 08-09\CUNNEEN'S BRIDGE\AUTOCAD\DESIGN PLANS NOV 08\PUBLIC DISPLAY DEC 08.DWG

No	DATE	DESIGN REVIEW	REV'D P.MGR	APP'D P.DIR	AMENDMENT
1	12.12.08	DM	DM		ISSUED FOR PUBLIC EXHIBITION

ISSUED FOR PUBLIC EXHIBITION
 DATE: 12-12-2008 SIGNED:

CESSNOCK CITY COUNCIL
 WORKS DEPARTMENT
 P.O. BOX 152 CESSNOCK
 PHONE 4993 4100 FAX 4993 2505

SHEET SCALES
 0 10 20 30 40 metres
 PLAN
 0 1 2 3
1:100 (INSET)

TITLE CUNNEEN'S BRIDGE REPLACEMENT - WOLLOMBI
 OPTION 1 - ORIGINAL DOWNSTREAM DESIGN
 ROAD DESIGN SPEED 60 km/h
 PROJECT No. / REF No. 4433
 AMDT 1
SHEET No. 1

OPTION 2

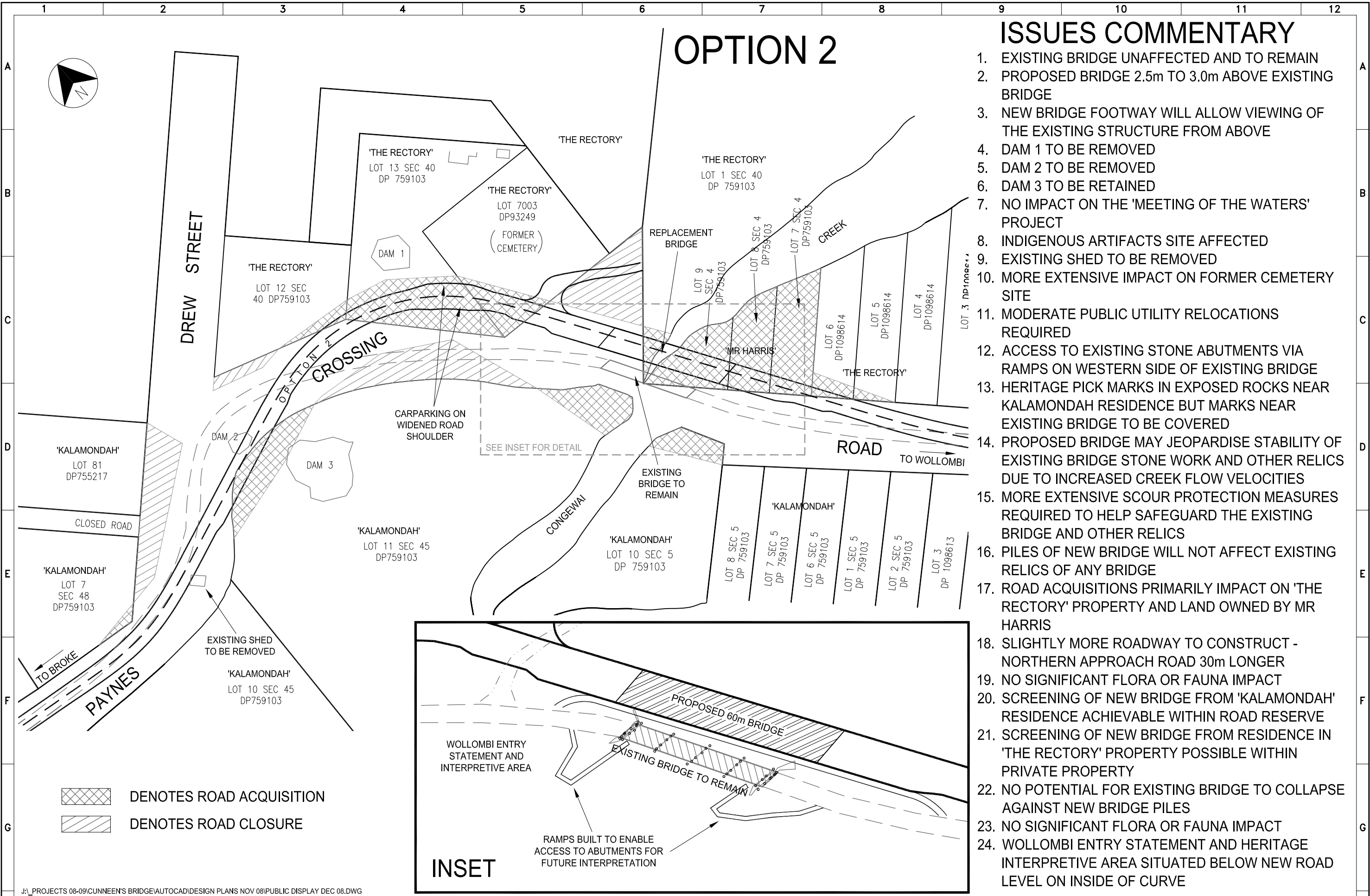

ISSUES COMMENTARY

1. EXISTING BRIDGE UNAFFECTED AND TO REMAIN
2. PROPOSED BRIDGE 2.5m TO 3.0m ABOVE EXISTING BRIDGE
3. NEW BRIDGE FOOTWAY WILL ALLOW VIEWING OF THE EXISTING STRUCTURE FROM ABOVE
4. DAM 1 TO BE REMOVED
5. DAM 2 TO BE REMOVED
6. DAM 3 TO BE RETAINED
7. NO IMPACT ON THE 'MEETING OF THE WATERS' PROJECT
8. INDIGENOUS ARTIFACTS SITE AFFECTED
9. EXISTING SHED TO BE REMOVED
10. MORE EXTENSIVE IMPACT ON FORMER CEMETERY SITE
11. MODERATE PUBLIC UTILITY RELOCATIONS REQUIRED
12. ACCESS TO EXISTING STONE ABUTMENTS VIA RAMPS ON WESTERN SIDE OF EXISTING BRIDGE
13. HERITAGE PICK MARKS IN EXPOSED ROCKS NEAR KALAMONDAH RESIDENCE BUT MARKS NEAR EXISTING BRIDGE TO BE COVERED
14. PROPOSED BRIDGE MAY JEOPARDISE STABILITY OF EXISTING BRIDGE STONE WORK AND OTHER RELICS DUE TO INCREASED CREEK FLOW VELOCITIES
15. MORE EXTENSIVE SCOUR PROTECTION MEASURES REQUIRED TO HELP SAFEGUARD THE EXISTING BRIDGE AND OTHER RELICS
16. PILES OF NEW BRIDGE WILL NOT AFFECT EXISTING RELICS OF ANY BRIDGE
17. ROAD ACQUISITIONS PRIMARILY IMPACT ON 'THE RECTORY' PROPERTY AND LAND OWNED BY MR HARRIS
18. SLIGHTLY MORE ROADWAY TO CONSTRUCT - NORTHERN APPROACH ROAD 30m LONGER
19. NO SIGNIFICANT FLORA OR FAUNA IMPACT
20. SCREENING OF NEW BRIDGE FROM 'KALAMONDAH' RESIDENCE ACHIEVABLE WITHIN ROAD RESERVE
21. SCREENING OF NEW BRIDGE FROM RESIDENCE IN 'THE RECTORY' PROPERTY POSSIBLE WITHIN PRIVATE PROPERTY
22. NO POTENTIAL FOR EXISTING BRIDGE TO COLLAPSE AGAINST NEW BRIDGE PILES
23. NO SIGNIFICANT FLORA OR FAUNA IMPACT
24. WOLLOMBI ENTRY STATEMENT AND HERITAGE INTERPRETIVE AREA SITUATED BELOW NEW ROAD LEVEL ON INSIDE OF CURVE

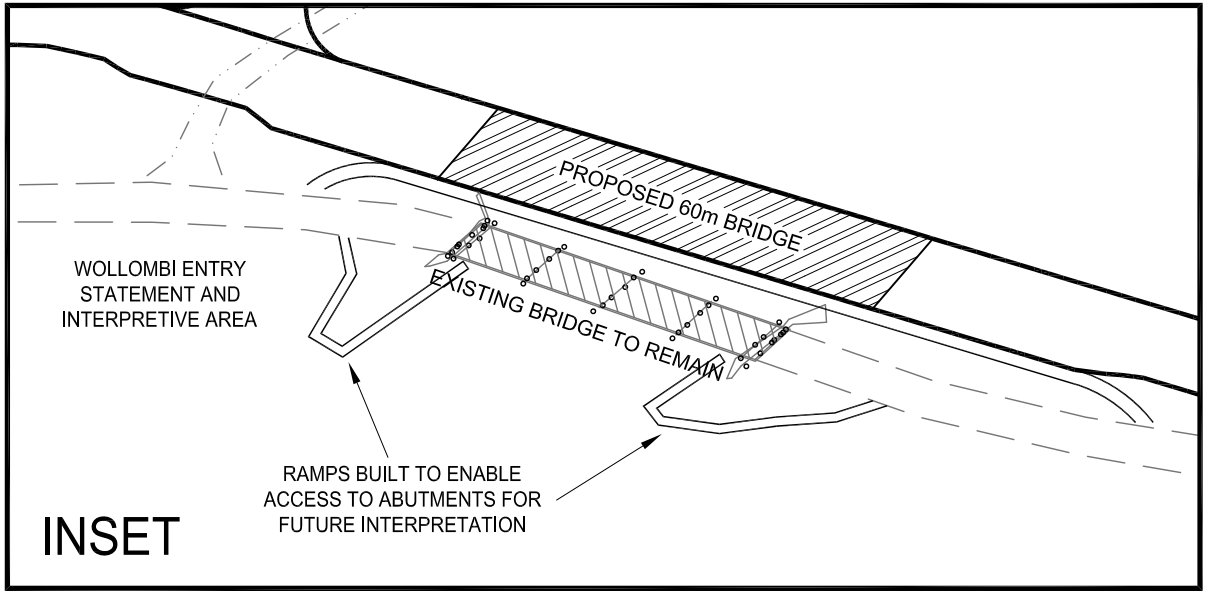

J:_PROJECTS 08-09\CUNNEEN'S BRIDGE\AUTOCAD\DESIGN PLANS NOV 08\PUBLIC DISPLAY DEC 08.DWG

No	DATE	DESIGN REVIEW	REV'D P.MGR	APP'D P.DIR	AMENDMENT
1	12.12.08	DM	DM		ISSUED FOR PUBLIC EXHIBITION

ISSUED FOR PUBLIC EXHIBITION
 DATE: 12-12-2008 SIGNED:

CESSNOCK CITY COUNCIL
 WORKS DEPARTMENT
 P.O. BOX 152 CESSNOCK
 PHONE 4993 4100 FAX 4993 2505

SHEET SCALES
 0 10 20 30 40 metres
 PLAN
 0 1 2 3
 1:100 (INSET)
 A3 SHEET



TITLE CUNNEEN'S BRIDGE REPLACEMENT - WOLLOMBI
 OPTION 2 - UPSTREAM DESIGN
 ROAD DESIGN SPEED 60 km/h
 PROJECT No. / REF No. 4433
 AMDT 1
 SHEET No. **2**

OPTION 3

ISSUES COMMENTARY

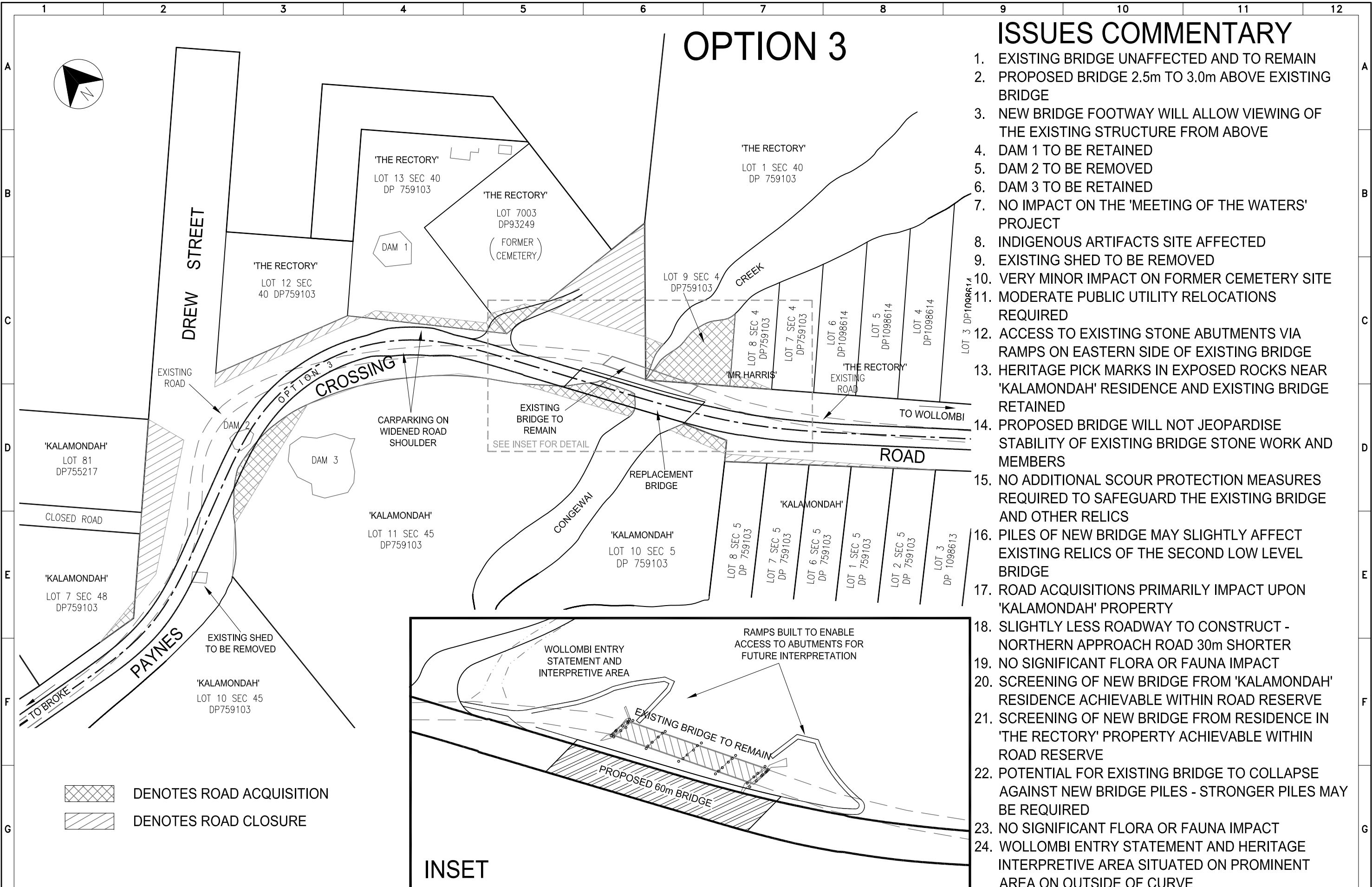
1. EXISTING BRIDGE UNAFFECTED AND TO REMAIN
2. PROPOSED BRIDGE 2.5m TO 3.0m ABOVE EXISTING BRIDGE
3. NEW BRIDGE FOOTWAY WILL ALLOW VIEWING OF THE EXISTING STRUCTURE FROM ABOVE
4. DAM 1 TO BE RETAINED
5. DAM 2 TO BE REMOVED
6. DAM 3 TO BE RETAINED
7. NO IMPACT ON THE 'MEETING OF THE WATERS' PROJECT
8. INDIGENOUS ARTIFACTS SITE AFFECTED
9. EXISTING SHED TO BE REMOVED
10. VERY MINOR IMPACT ON FORMER CEMETERY SITE
11. MODERATE PUBLIC UTILITY RELOCATIONS REQUIRED
12. ACCESS TO EXISTING STONE ABUTMENTS VIA RAMPS ON EASTERN SIDE OF EXISTING BRIDGE
13. HERITAGE PICK MARKS IN EXPOSED ROCKS NEAR 'KALAMONDAH' RESIDENCE AND EXISTING BRIDGE RETAINED
14. PROPOSED BRIDGE WILL NOT JEOPARDISE STABILITY OF EXISTING BRIDGE STONE WORK AND MEMBERS
15. NO ADDITIONAL SCOUR PROTECTION MEASURES REQUIRED TO SAFEGUARD THE EXISTING BRIDGE AND OTHER RELICS
16. PILES OF NEW BRIDGE MAY SLIGHTLY AFFECT EXISTING RELICS OF THE SECOND LOW LEVEL BRIDGE
17. ROAD ACQUISITIONS PRIMARILY IMPACT UPON 'KALAMONDAH' PROPERTY
18. SLIGHTLY LESS ROADWAY TO CONSTRUCT - NORTHERN APPROACH ROAD 30m SHORTER
19. NO SIGNIFICANT FLORA OR FAUNA IMPACT
20. SCREENING OF NEW BRIDGE FROM 'KALAMONDAH' RESIDENCE ACHIEVABLE WITHIN ROAD RESERVE
21. SCREENING OF NEW BRIDGE FROM RESIDENCE IN 'THE RECTORY' PROPERTY ACHIEVABLE WITHIN ROAD RESERVE
22. POTENTIAL FOR EXISTING BRIDGE TO COLLAPSE AGAINST NEW BRIDGE PILES - STRONGER PILES MAY BE REQUIRED
23. NO SIGNIFICANT FLORA OR FAUNA IMPACT
24. WOLLOMBI ENTRY STATEMENT AND HERITAGE INTERPRETIVE AREA SITUATED ON PROMINENT AREA ON OUTSIDE OF CURVE



 DENOTES ROAD ACQUISITION
 DENOTES ROAD CLOSURE

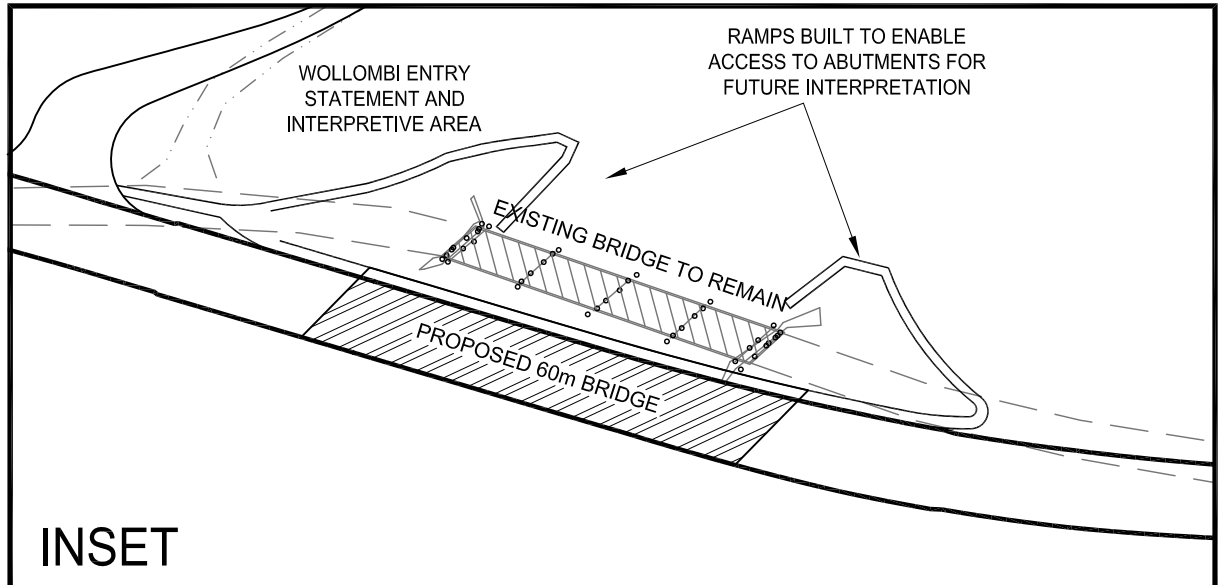

J:_PROJECTS 08-09\CUNNEEN'S BRIDGE\AUTOCAD\DESIGN PLANS NOV 08\PUBLIC DISPLAY DEC 08.DWG

No	DATE	DESIGN REVIEW	REV'D P.MGR	APP'D P.DIR	AMENDMENT
1	12.12.08	DM	DM		ISSUED FOR PUBLIC EXHIBITION

ISSUED FOR PUBLIC EXHIBITION
 DATE: 12-12-2008 SIGNED:

CESSNOCK CITY COUNCIL
 WORKS DEPARTMENT
 P.O. BOX 152 CESSNOCK
 PHONE 4993 4100 FAX 4993 2505

SHEET SCALES
 0 10 20 30 40 metres
 PLAN
 0 1 2 3
 1:100 (INSET)
 A3 SHEET

TITLE CUNNEEN'S BRIDGE REPLACEMENT - WOLLOMBI
 OPTION 3 - REVISED DOWNSTREAM DESIGN
 ROAD DESIGN SPEED 60 km/h
 PROJECT No. / REF No. 4433
 AMDT 1
 SHEET No. **3**